

COLUMN BASE CONNECTION ( FOR REFERENCE ONLY)

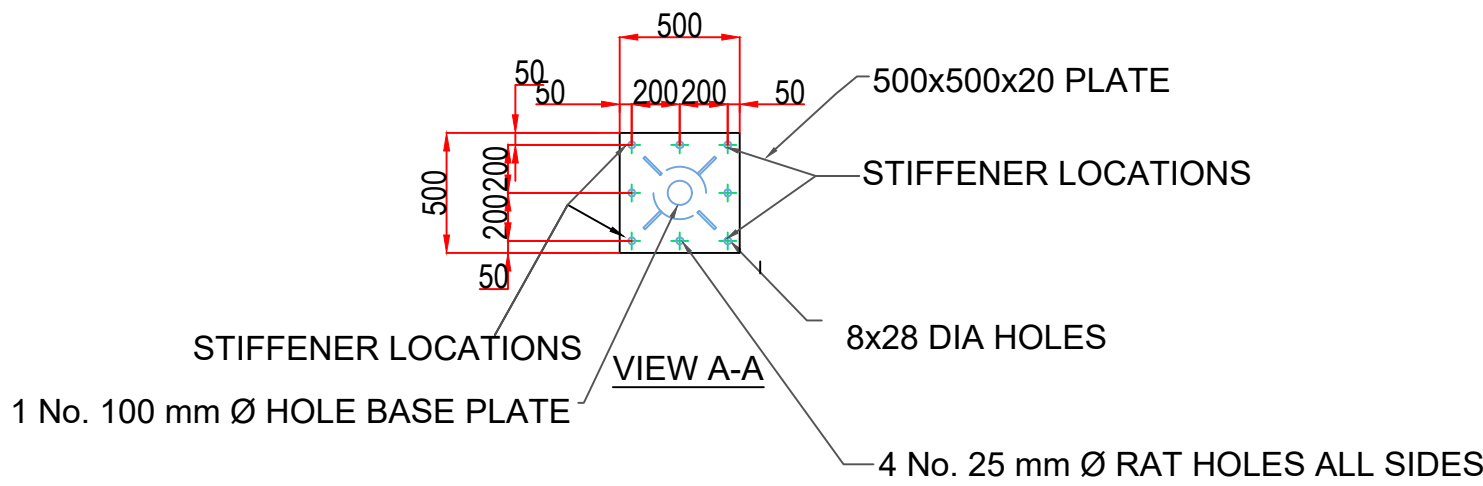

ALL ITEMS ARE WELDED TOGETHER BY 8 mm CFW

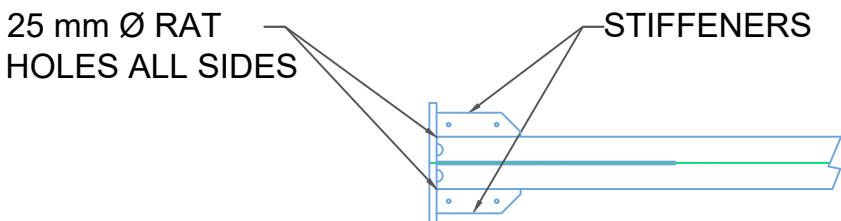

VIEW B-B

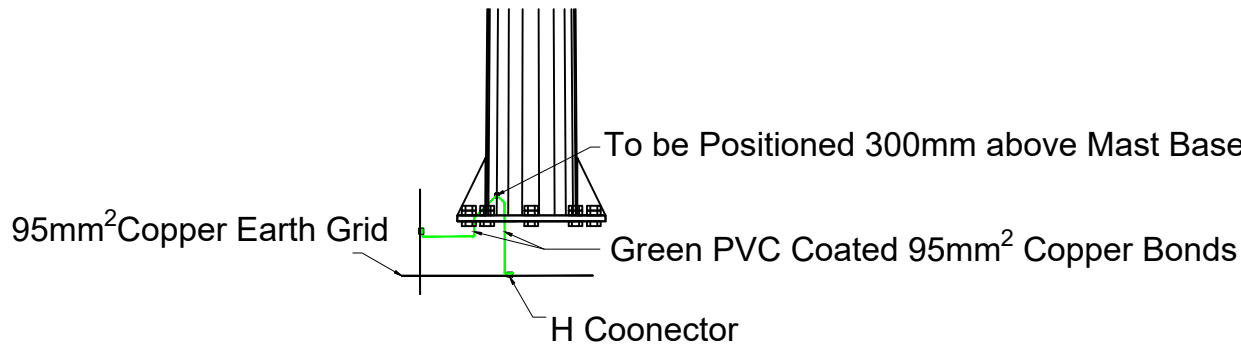

Monopole Base Plate to Earth Grid

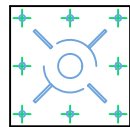

BASE PLATE : 500x500x30mm S275  
8 No. M20(Grade 8.8) x 500mm LONG, HOLE  
DIAMETER 26mm  
100x15x100 ANCHOR PLATES

NOTES:

1. ALL DIMENSIONS ARE IN mm UNLESS OTHERWISE STATED.

LEGEND:

KEY PLAN  
NOT TO SCALE

Rev	Date	Description	CHK	APP
02	29/11/2024	Project title updated		
01	09/10/2024	ISSUED FOR PLANNING		

Revisions

Client:

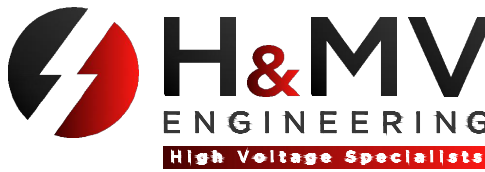

Unit 35, McLoughlin Road, National Technology Park,  
Castletroy, Limerick  
Tel: 061 357496 Fax: 061 514736  
www.hmveng.ie  
Email: info@hmveng.ie

Project: SCEIRDE ROCKS OFFSHORE WIND FARM

Title: LIGHTNING MAST DETAILS

Date: 29/11/2024	Drawn: DR	Designed By: MT	Checked By:	Approved By:
Scale: NTS	Project No: A1111	Project Status: -		

Project Code Originator Volume Level Type Disc Doc. No Sheet. No

IRE-HMV-ONS-EL-PD-2001

Status Code: -	Suitability Description:	Revision: 02
-------------------	--------------------------	-----------------

COPYRIGHT H&MV ENGINEERING LIMITED  
All rights reserved. No part of this work may be amended, copied or reproduced in any form or manner or by  
any means whether graphic, electronic or mechanical, including but not limited to photocopying, recording,  
capturing, or information and retrieval systems, or used for any other purpose but its designated one, without  
the written consent of H&MV ENGINEERING LIMITED.